

# Robur S2-Skåp | Användarmanual



## 1 Användning

Låset kan användas med två separata 6-8-siffriga koder, PIN1 och PIN2 men att använda två koder är inte nödvändigt. Skåpet är programmerat med en kod, PIN1 är vid leverans 1-2-3-4-5-6.

## 2 Signaler

🔊 + ●

Enkel ljudsignal + Grön lampa blinkar en gång:  
Bekräftar att låset är okej.

🔊 🔊 + ● ●

Dubbel ljudsignal + Grön lampa blinkar två gånger: Bekräftar att programmering lyckades.

🔊 + ● ● ●

En lång ljudsignal + blinkande Röd lampa: Någonting blev fel

🔊 🔊 🔊 🔊 🔊 + ● ● ● ● ●

Fem ljudsignaler + Röd lampa blinkar fem gånger: Låg batterispänning

## 3 Öppna skåpet

3.1 Öppna med förprogrammerad (1-2-3-4-5-6) eller ändrad PIN1-kod:  
[ON] [PIN1] [ENTER] Vrid handtaget medurs ↻

3.2 Öppna med tillagd PIN2-kod:  
[ON] [PIN2] [ENTER]

3.3 Låsa skåpet  
Stäng dörren och vrid handtaget moturs ↻

# Robur S2-Skåp | Användarmanual

## 4 Programmera låset **Observera! All programmering görs med öppen, olåst dörr.**

### 4.1 Byt PIN1-kod

[ON] [ENTER] [1] [ENTER] [PIN1] [ENTER] [ny PIN1] [ENTER] [repetera ny PIN1] [ENTER]

### 4.2 Programera ny eller byt PIN2-kod – Obs, att använda två koder är Inte nödvändigt.

[ON] [ENTER] [2] [ENTER] [PIN1] [ENTER] [ny PIN2] [ENTER] [repetera ny PIN2] [ENTER]

### 4.3 Byt PIN2-kod utan PIN1-kod – Obs, att använda två koder är Inte nödvändigt.

[ON] [ENTER] [3] [ENTER] [PIN2] [ENTER] [ny PIN2] [ENTER] [repetera ny PIN2] [ENTER]

### 4.4 Ta bort PIN2-kod

[ON] [ENTER] [0] [ENTER] [PIN1] [ENTER]

## 5 Byta batteri

- 5.1 Beroende på skåpmodell sitter batterierna antingen i låset eller på dörrens ovkant. I båda fallen är batterihållaren placerad på dörrens insida. På de mindre skåpen sitter batterihållaren på dörrens ovkant, se fig. 2.

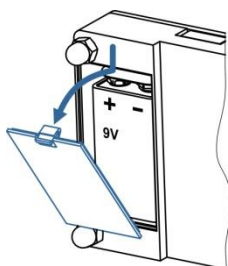

Fig. 1

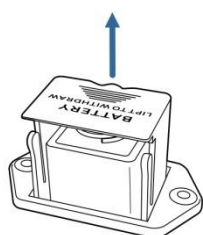

Fig.2

### 5.2 Nödöppning

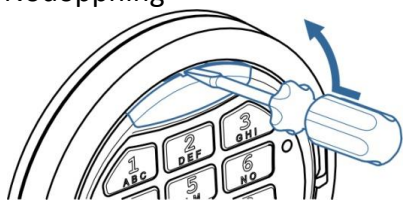

Fig. 1

Lossa täckbrickan på knappsatsens ovkant med hjälp av en skruvmejsel, se fig. 1.

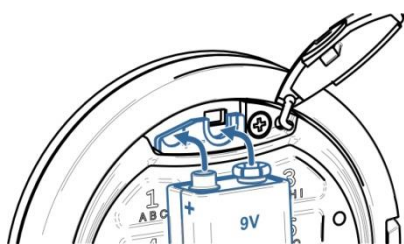

Fig. 2

Håll emot ett 9V batteri och slå koden, se fig. 2.

Öppna och byt batteri på dörrens insida.

## S2-Safe - Digital Lock PS300/E31

### USER MANUAL

#### 1 Main Components

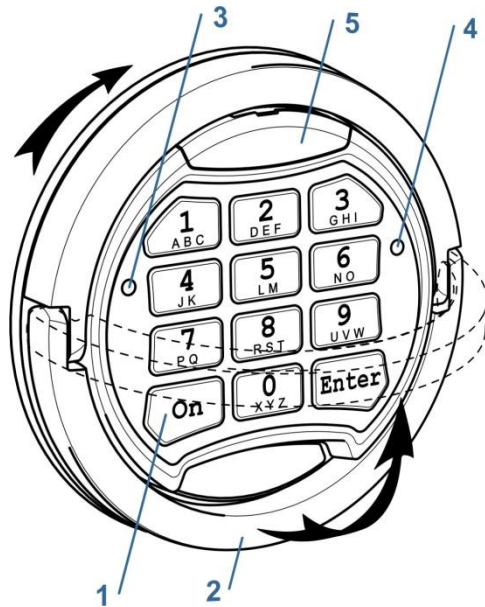

Image 1.1

- 1 – Keypad
- 2 – Folding handle
- 3 – Green LED [G]
- 4 – Red LED [R]
- 5 – Plastic cover for emergency power

#### 2 Definitions

##### 2.1 Master Code [PIN1]

A set of numbers (from 6 to 8 digits) which opens the lock and allows to operate the settings.

**!** Before using the safe, please change the factory Master code (see par.4.1). It is strongly recommended to keep the master code safe from unauthorized people.

**✓** Factory Master Code:  
1-2-3-4-5-6

##### 2.2 User Code [PIN2]

A set of numbers from 6 to 8 digits which opens the lock and has limited functions to change the settings.

**✓** The lock with default factory settings does not have the User code. Please see par.4.2 to set the User code.

##### 2.3 Signals

[G]<sup>1</sup> Short single acoustic signal with single green LED flash (3) – confirmation of the button pressing on the keypad.

[G]<sup>2</sup> Short double acoustic signal with double green LED flash (3) – confirmation of successfully finished operation.

[R]-- Long single acoustic signal with single red LED flash (4) – error message.

[R]<sup>5</sup> Short acoustic signal sounds 5 times with 5 red LED flashes (4) – low battery message. Please see par.5.1 how to change the battery.

#### 3 Main Functions

##### 3.1 Opening the Lock

3.1.1 Opening with the Factory Master code  
[ON] [1] [2] [3] [4] [5] [6] [Enter]

3.1.2 Opening with the Master Code  
[ON] [PIN1] [Enter]

3.1.3 Opening with the User Code  
[ON] [PIN2] [Enter]

If the code is right, there will be a green LED flash and it will be possible to open the door within 5 seconds by turning the handle (2) clockwise.

**!** If you enter a wrong code three times in a row, the lock will be blocked for 5 minutes. The blocking of the lock will be indicated periodical red LED flashes.

##### 3.2 Closing the Lock

Close the door and turn the handle (2) anti-clockwise until it stops.

#### 4 Service Functions

**!** It is strongly recommended to change the settings of the lock with the door opened.

**✓** The service functions will be unavailable in case low power supply which is indicated by the signals. [R]<sup>5</sup>.

#### 4.1 Changing the Master Code [PIN1]

[ON] [Enter] [1] [Enter]  
 [PIN1] [Enter]  
 [new PIN1] [Enter]  
 [repeat new PIN1] [Enter]

Checking the new Master code:

[ON] [new PIN1] [Enter]

#### 4.2 Changing the User Code [PIN2] with the Master Code [PIN1]

[ON] [Enter] [2] [Enter]  
 [PIN1] [Enter]  
 [new PIN2] [Enter]  
 [repeat new PIN2] [Enter]

Checking the new User code:

[ON] [new PIN2] [Enter]

#### 4.3 Changing the User Code [PIN2] without the Master Code

[ON] [Enter] [3] [Enter]  
 [PIN2] [Enter]  
 [new PIN2] [Enter]  
 [repeat new PIN2] [Enter]

Checking the new User Code:

[ON] [new PIN2] [Enter]

#### 4.4 Deleting the User Code

[ON] [Enter] [0] [Enter]  
 [PIN1] [Enter]

## 5 Servicing

### 5.1 Changing the Battery

- The battery is located on the inner side of the door. Depending on the safe model, battery could be either inside the lock battery compartment (image 5.1a) or in a special pull-out battery box (image 5.1b).



*The exact location of the battery compartment or the batter box could be different depending on the safe model.*

- Take out the cover of the battery compartment of the lock (see Image 5.1a) or pull out the box (see Image 5.1b).

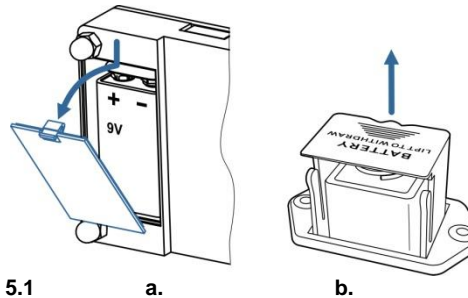

Image 5.1

- Install a new battery (9V, type 6LF22).
- Take the cover or the box back to their location.

### 5.2 Opening the lock when the Battery is Discharged

- Take a new battery (9V, type 6LF22).
- Take out the plastic cover for emergency power (5), see Image 5.2.

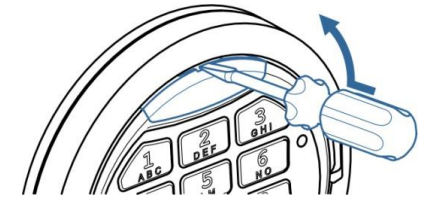

Image 5.2

- Press the new battery to emergency power pins and fix it in this position (see Image 5.3).



*Do not make the battery's contacts to the metal parts of the lock in order to prevent possible discharging of the battery.*

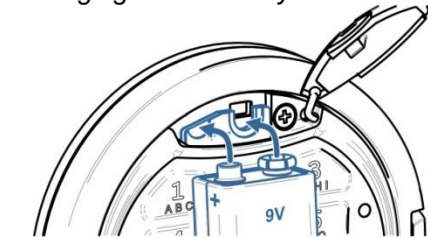

Image 5.3

- Enter the valid code on the keypad (1).
- Disconnect the emergency battery, open the door and change the discharged battery, see par. **Fel! Hittar inte referenskölla..**